









SAND POND CONSERVATION AREA

RIPLEY COUNTY
302 ACRES

AA

LEGEND

- Boundary 
- Paved Road 
- Gravel Road 
- Pipeline 
- Parking Lot 
- Forest 
- Natural Area 
- Topography 

SCALE



VICINITY MAP

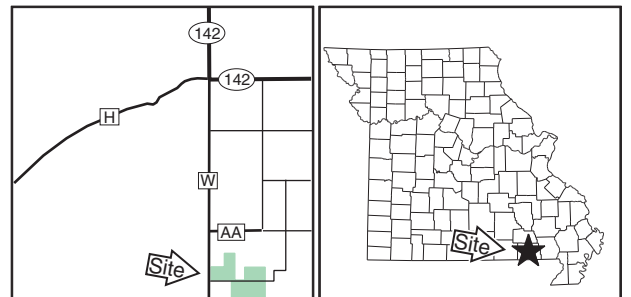

W

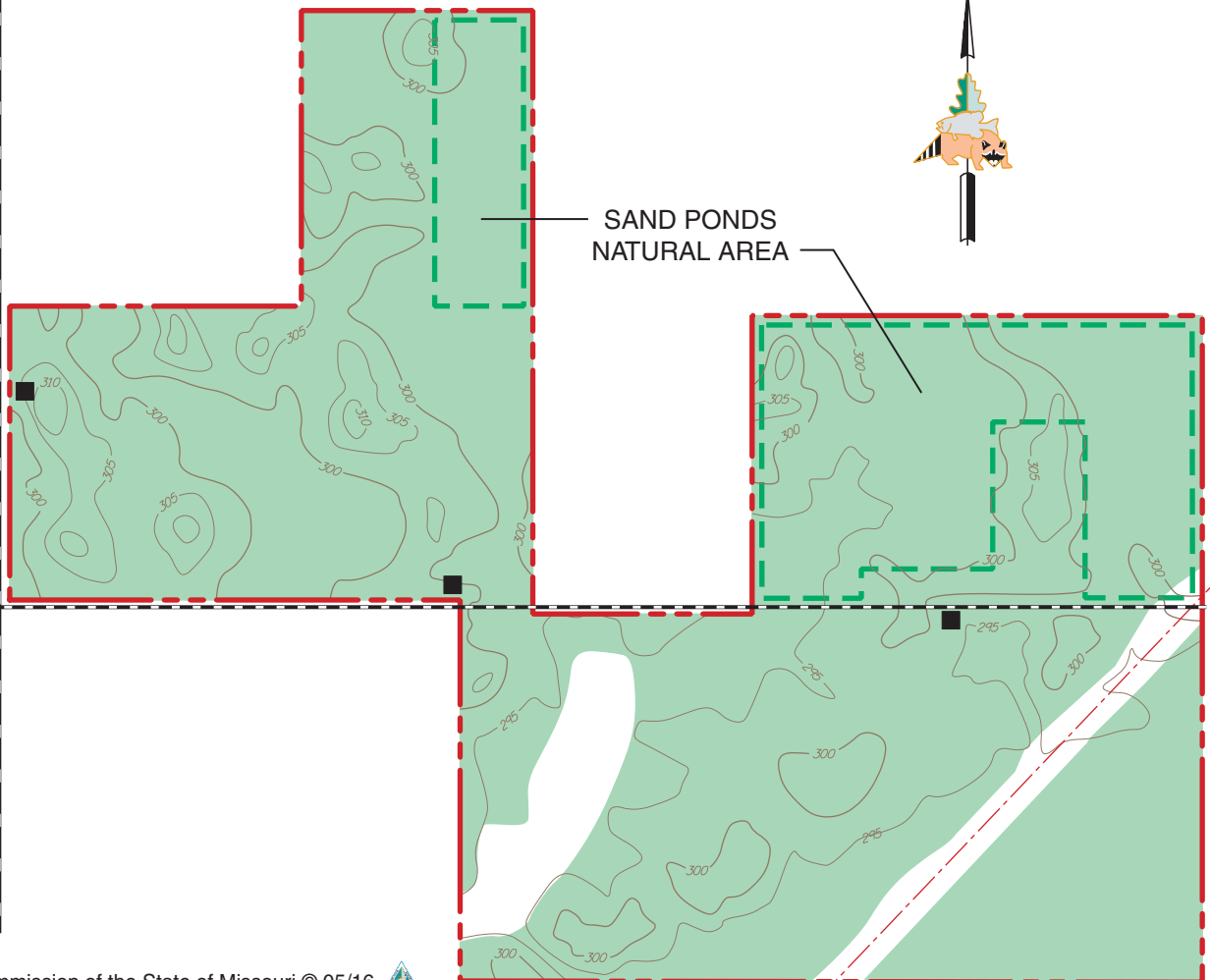

SAND PONDS
NATURAL AREA

