







F.O. AND LEDA J. SEARS MEMORIAL WILDLIFE AREA

**AUDRAIN COUNTY
160 ACRES**

LEGEND

- Boundary 
- Paved Road 
- Drainage 
- Parking Lot 
- Forest 
- Topography 

VICINITY MAP

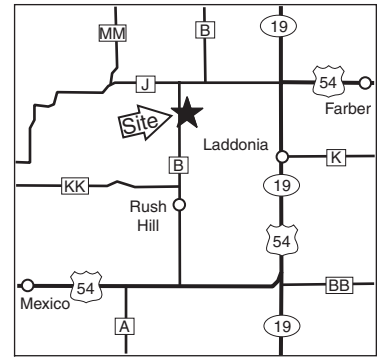

NO HUNTING - WILDLIFE REFUGE

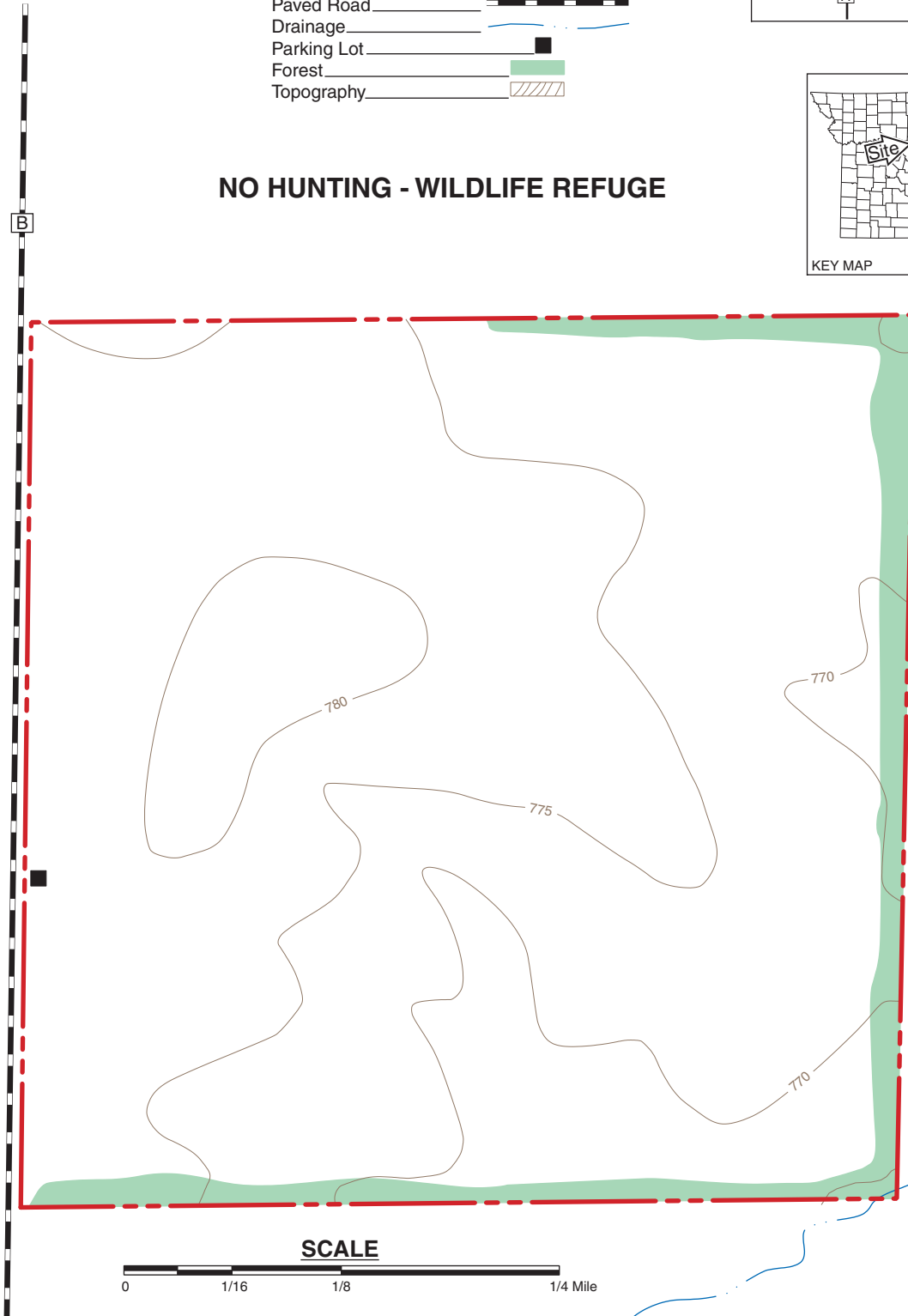

SCALE

