

# MOCKINGBIRD HILL ACCESS

GRUNDY COUNTY  
80 ACRES

SCALE

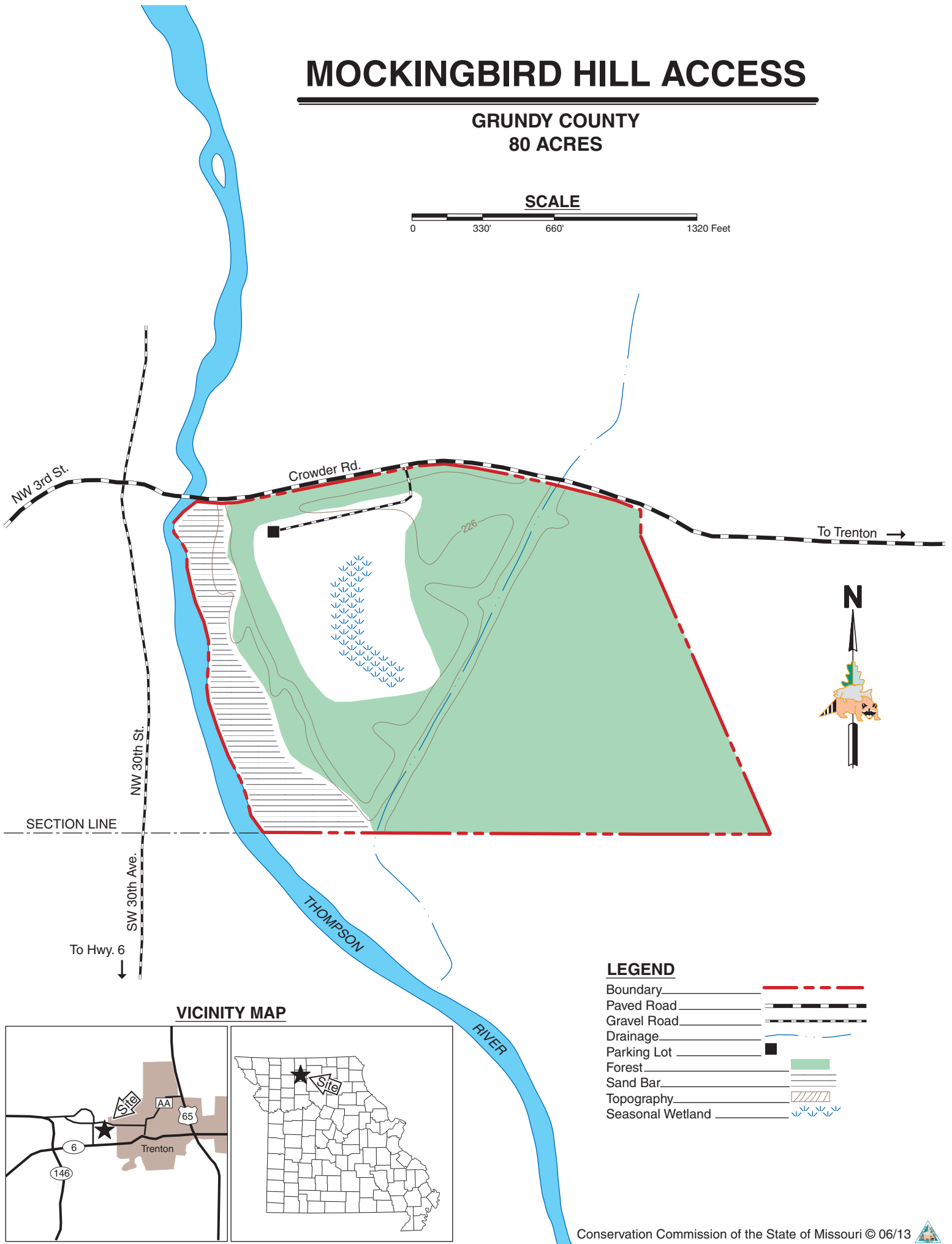

SECTION LINE

NW 3rd St.

Crowder Rd.

To Trenton →

NW 30th St.

To Hwy. 6 ↓

SW 30th Ave.

THOMPSON RIVER

## LEGEND

- Boundary
- Paved Road
- Gravel Road
- Drainage
- Parking Lot
- Forest
- Sand Bar
- Topography
- Seasonal Wetland

## VICINITY MAP

